

CS[®] ADAPTER Non-Shuttered 1 (2F), 2 (4F), and 4-Channel (8F)

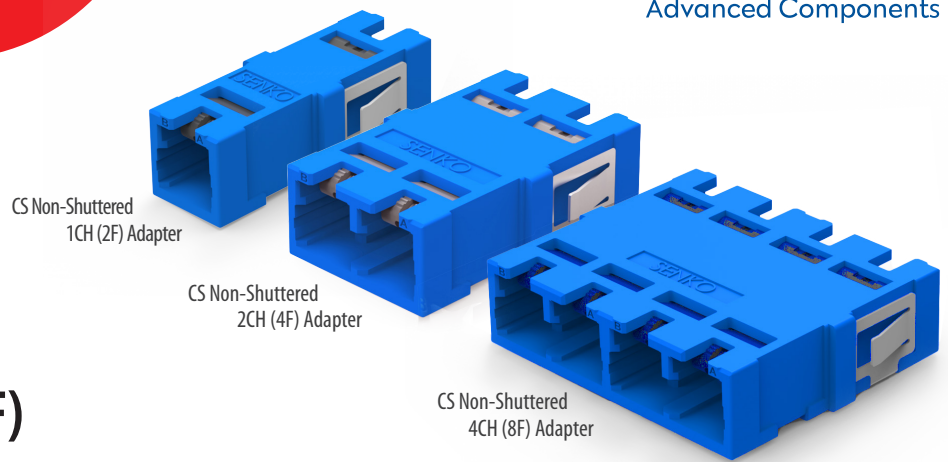

SENKO's CS[®] adapters offer a range of non-shuttered options to cater to various fiber channel requirements. These adapters are available in three configurations: 1-channel (accommodating 2 fibers), 2-channel (accommodating 4 fibers), and 4-channel (accommodating 8 fibers).

The 1-channel adapter is specifically designed for applications that necessitate the segregation of individual optical channels, such as coherent optics or wave-splitting. On the other hand, the 2-channel and 4-channel variants prioritize maximizing patch panel density. The 4-channel adapter is particularly compatible with Base-8 applications, which are commonly deployed in data centers. These CS[®] adapters can be mounted horizontally or vertically, allowing for flexible configurations and density levels per 1RU (rack unit). This versatility enables the achievement of various density levels, ranging from 144 fibers per 1RU to an impressive 288 fibers per 1RU. This density is twice that of traditional LC-based patch panels.

It's important to note that these CS[®] adapters are not retro-fittable to standard SC/LC cut-outs. Instead, they require a special aperture for installation. A metal spring clip securely holds the adapter in place, while large apertures in the upper face of the adapter clearly indicate the correct key alignment for connector insertion.

FEATURES

- Premium one-piece body design
- Up to 360 fibers per 1RU
- Accepts CS[®] standard and junior connectors
- Supports 200G/400G VSFF connectivity
- Color-coded for rapid identification of fiber-type
- Telcordia, ANSI, TIA and IEC compliant
- Identification aperture for fast and simple connector alignment

APPLICATIONS

- High-density patch panels
- LGX patching modules
- MPO-CS[®] transition modules and panels
- Opto-electronic equipment
- WDM equipment
- MUX and DEMUX equipment
- Mass server consolidation EoR, MoR

Mechanical Data

	Value
Durability	500 matings per TIA-568
Fixing Method	Snap-fit (<i>adapter without flange</i>) or screw and nut (<i>adapter with flange</i>)
Housing Material Type	Plastic
Fixing Spring Material Type	Metal stainless steel
Sleeve Material	Zirconia
Dust Protection Method	Removable dust plugs

Optical Data

	Value
Typical Insertion Loss (dB)*	0.10
Max. Insertion Loss (dB)*	0.20

* Based on master grade jumper to low loss random mating test

Environmental Data

	Value
Operating Temperature	-40°C to +75°C
RoHS Compliance	2015/863 RoHS
REACH Compliance	Yes
Free of Halogen	Yes
Humidity Resistance	95%

CS[®] ADAPTER

1-channel (2F), 2-channel (4F) and 4-channel (8F)

SN ADAPTER DATA SHEET

1-Channel Adapter Drawing

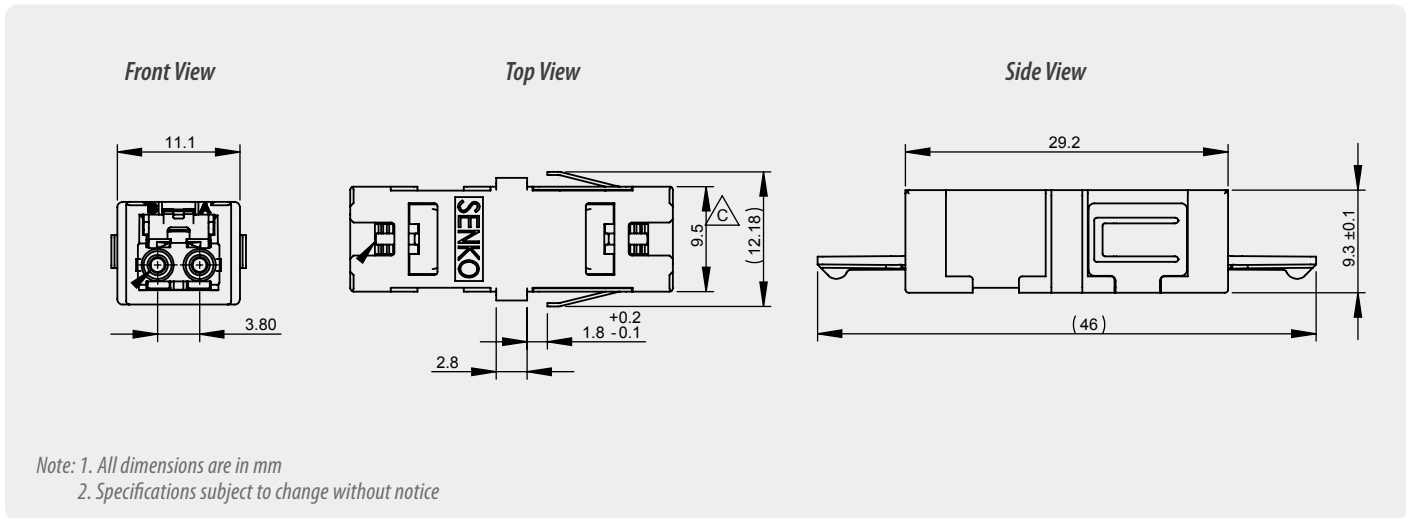

2-Channel Adapter Drawing

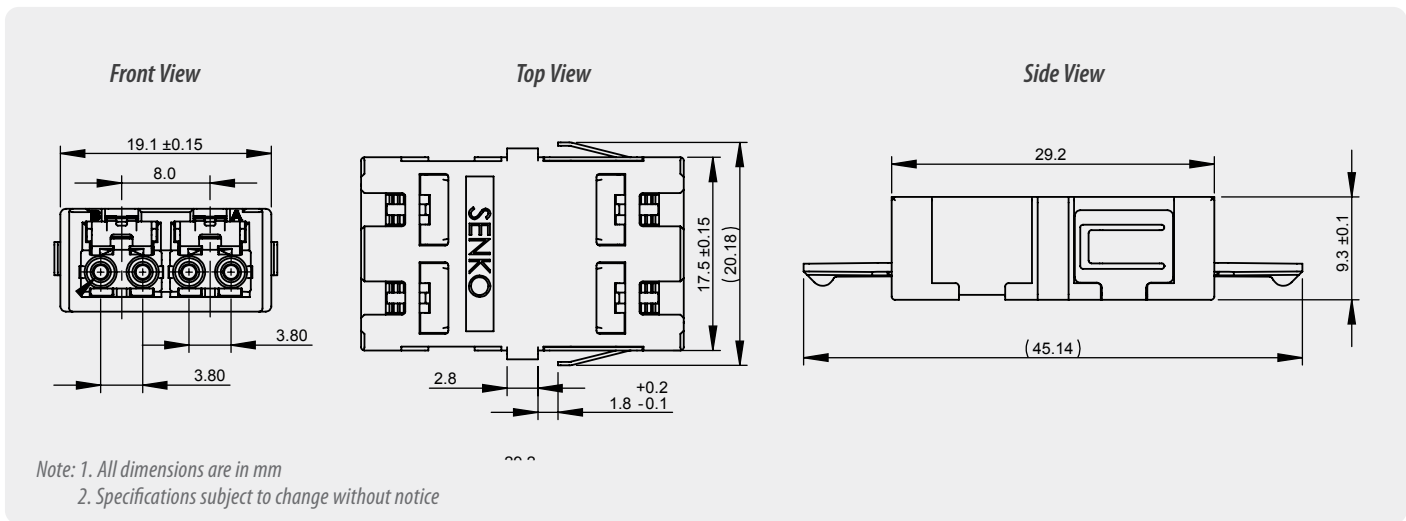

ORDERING

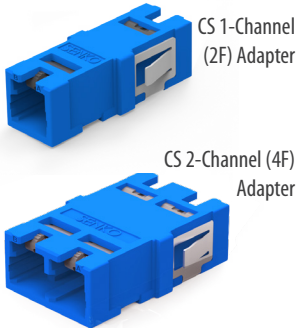

ADAPTER TYPE		FLANGE		HOUSING COLOR	
681	CS 1-Channel (2F) Adapter	1	With Flange	1	Blue
682	CS 2-Channel (4F) Adapter	2	Without Flange	3	Green
				7	Heather Violet
				9	Aqua

682 - 11 ORDER CODE example

Note: Adapter supplied with protective dust-cap on both sides

4-Channel Adapter Drawing

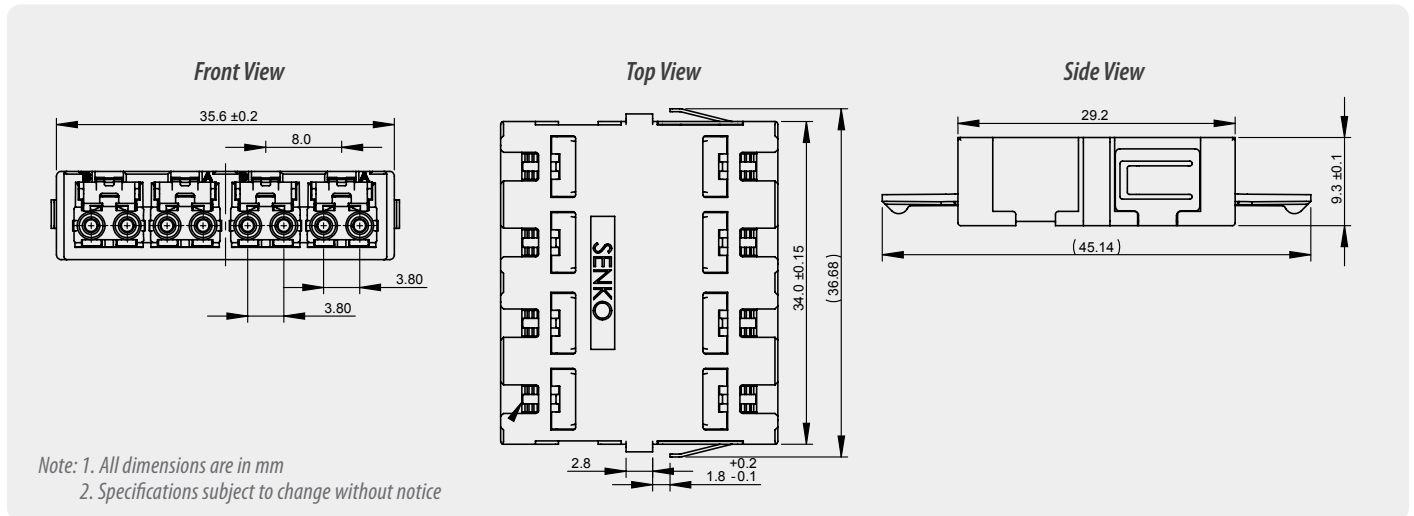

ORDERING

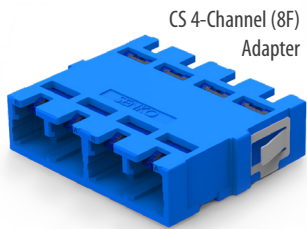

ADAPTER TYPE		FLANGE		HOUSING COLOR	
684	CS 4-Channel (8F) Adapter	1	With Flange	1	Blue
		2	Without Flange	3	Green
				7	Heather Violet
				9	Aqua

684 - 11 ORDER CODE example

Note: Adapter supplied with protective dust-cap on both sides

SENKO[®]

Advanced Components

sales@senko.com
1-858-623-3300

senko.com/contact